

DETALHE CALÇADA DE CONCRETO  
ESCALA: 1/20

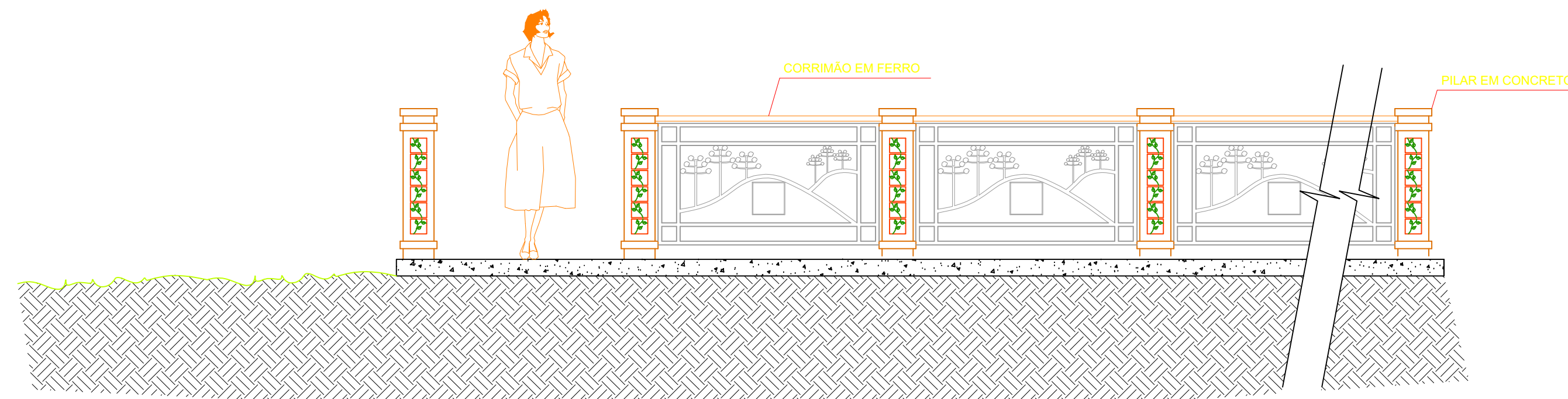

DETALHE ESQUEMÁTICO DA PASSARELA 01  
ESCALA: 1/20

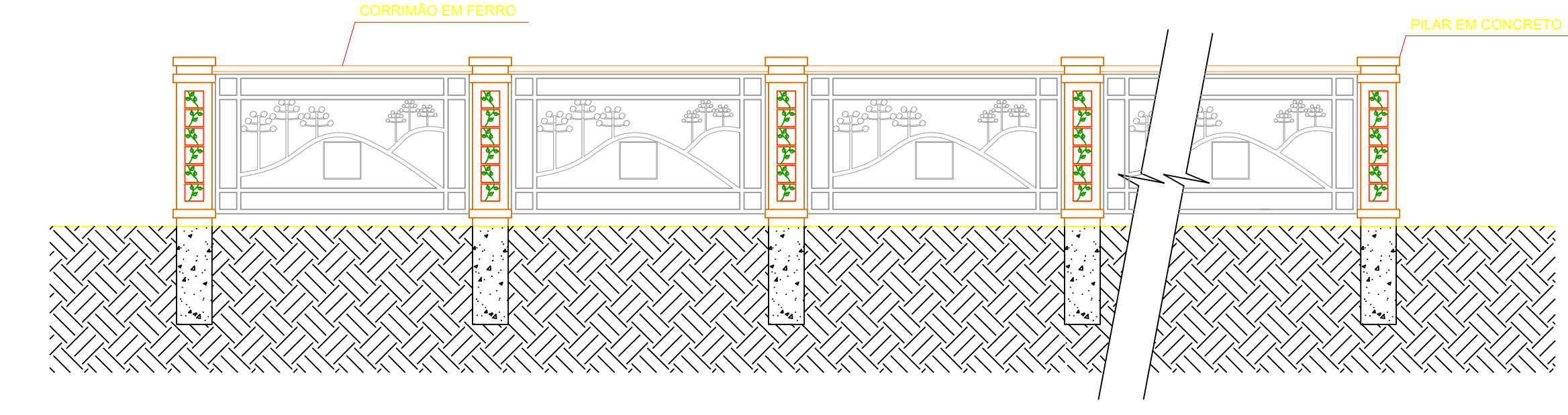

VISTA LATERAL DO GRADIL  
ESCALA: 1/20

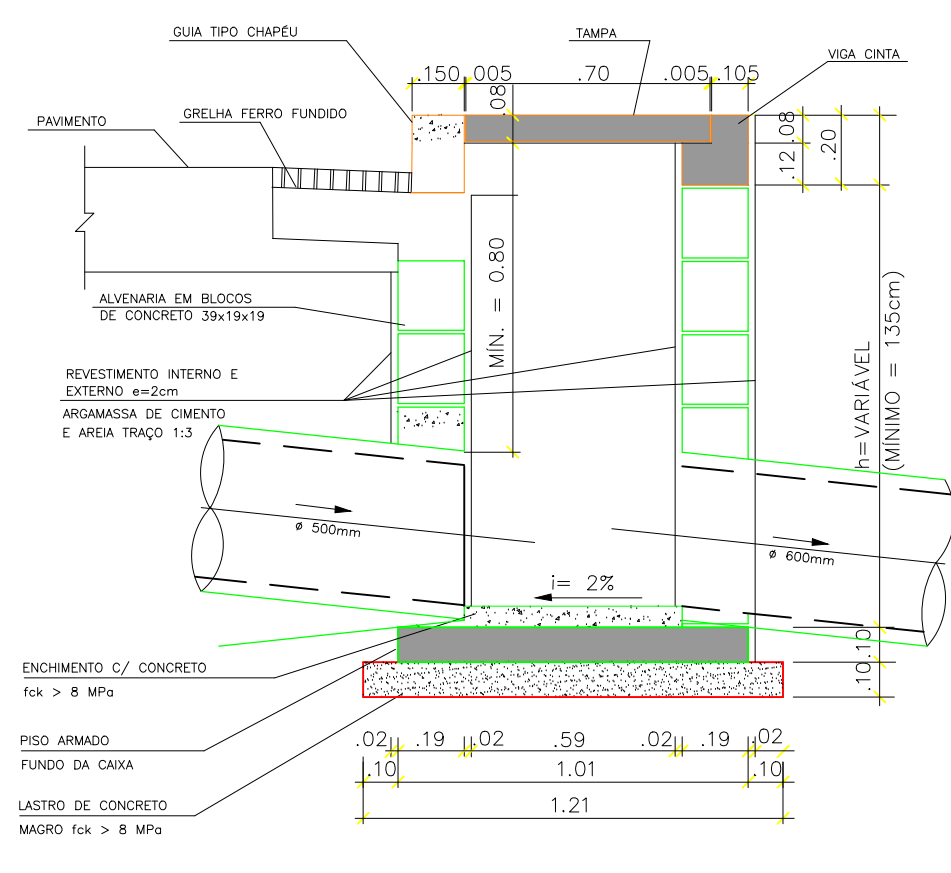

CORTE - BOCA DE LOBO  
SEM ESCALA

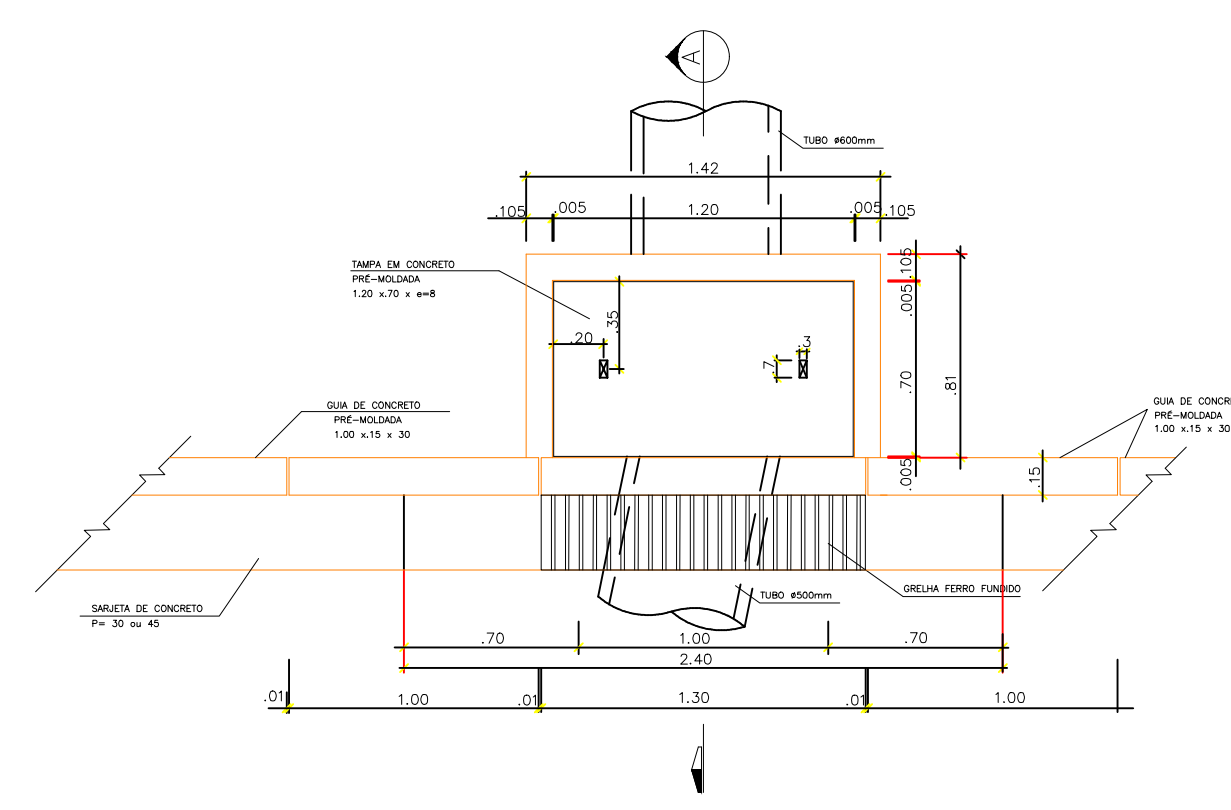

PLANTA - BOCA DE LOBO  
SEM ESCALA

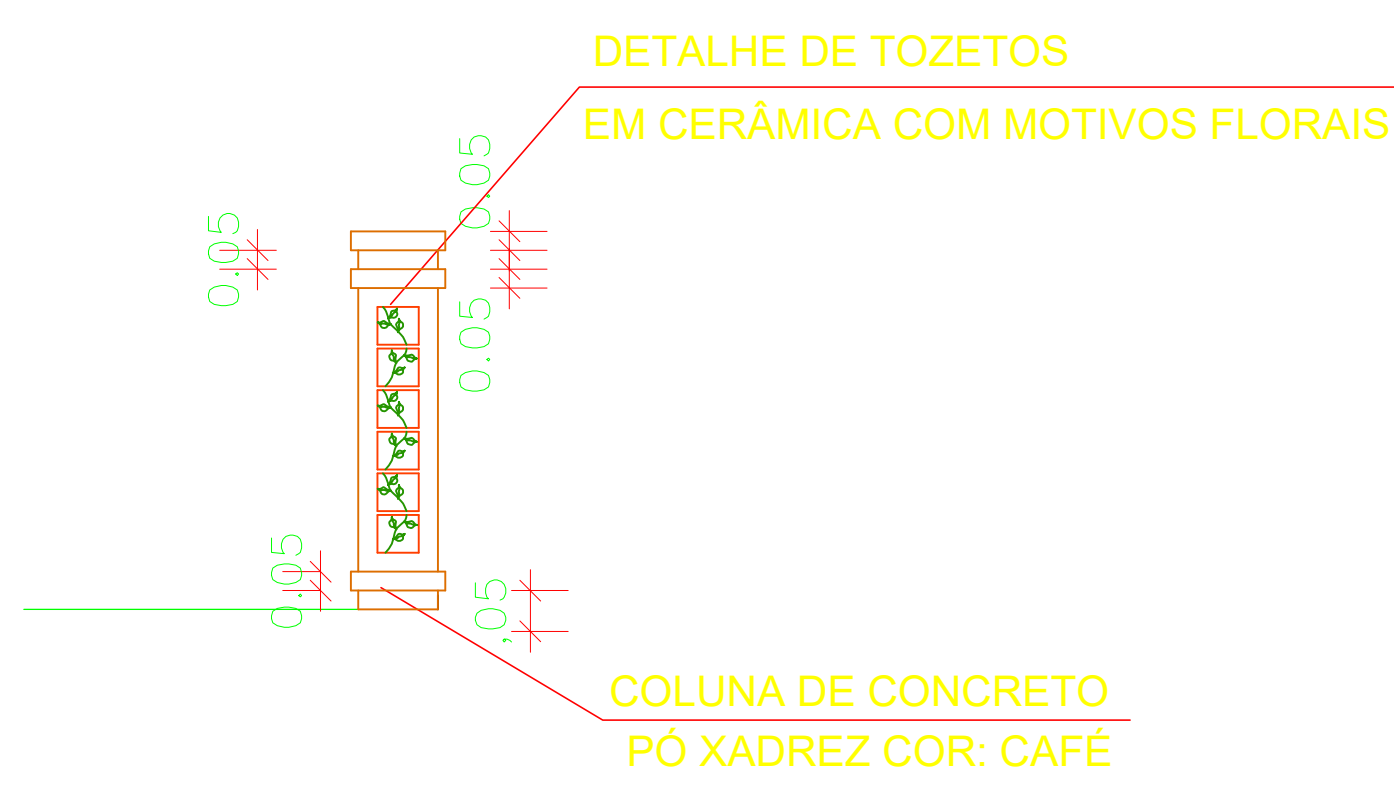

VISTA LATERAL - COLUNAS  
ESCALA: 1/20

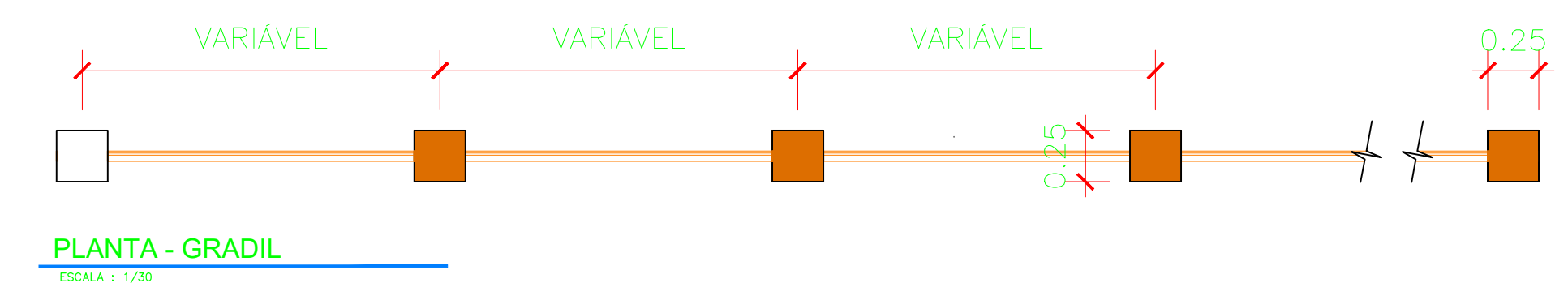

PLANTA - GRADIL  
ESCALA: 1/20

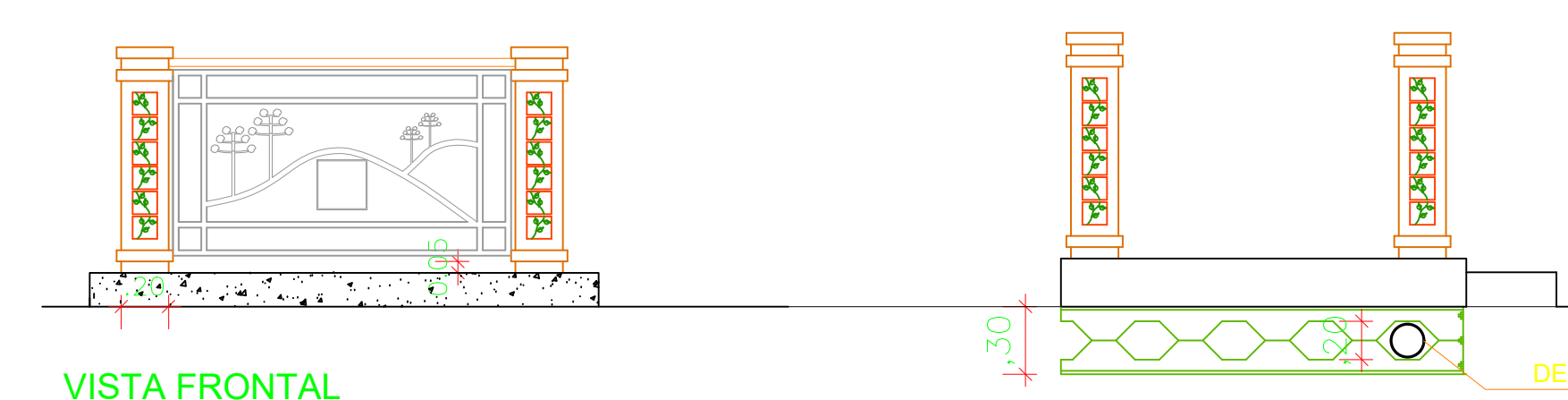

VISTA LATERAL  
ESCALA: 1/30

VISTA FRONTAL  
ESCALA: 1/30

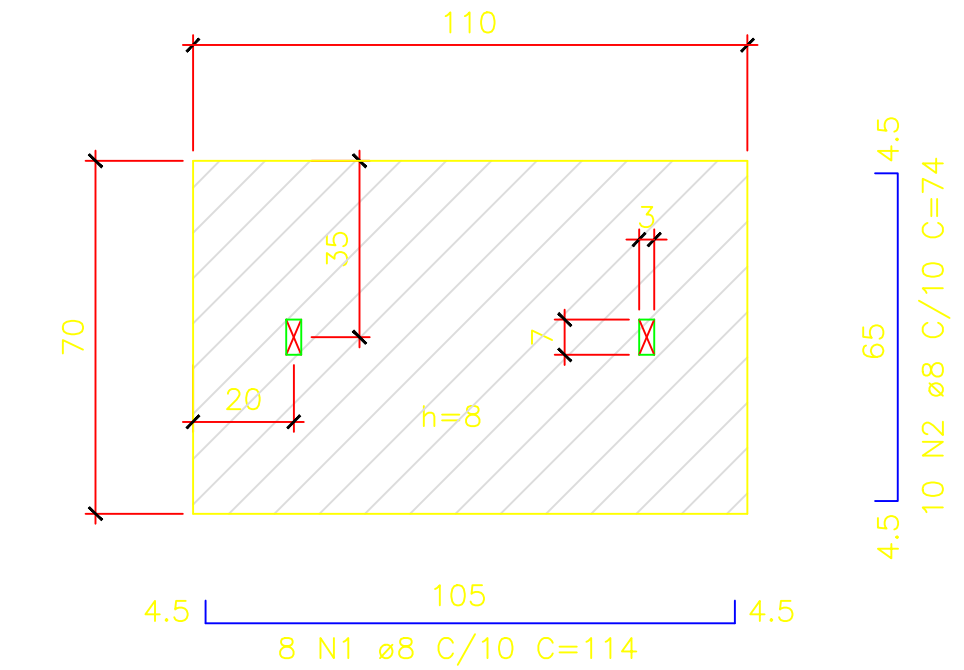

LAJE DA TAMPA DE BOCA DE LOBO  
SEM ESCALA

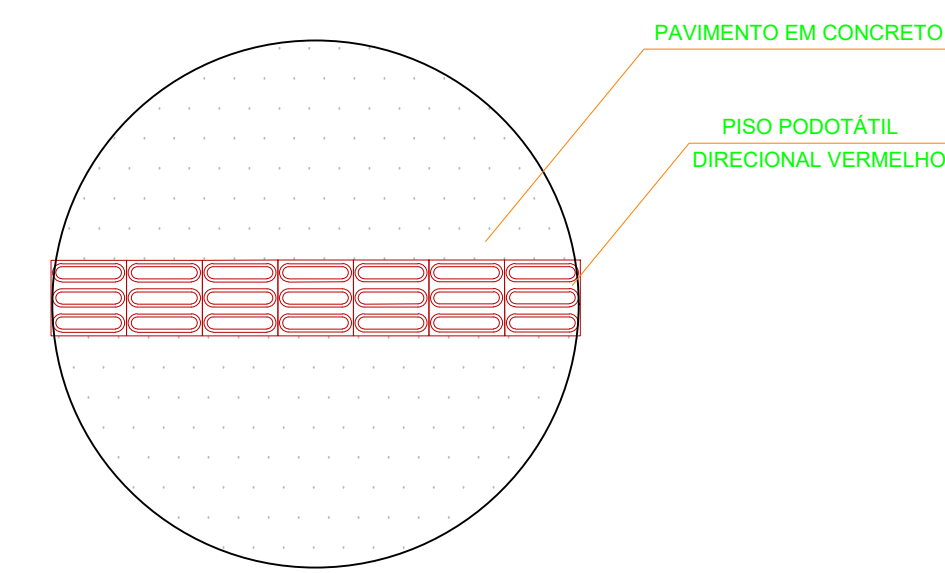

DETALHE / PLANTA - COLOCAÇÃO EM PISO DE CONCRETO  
ESCALA: 1/20

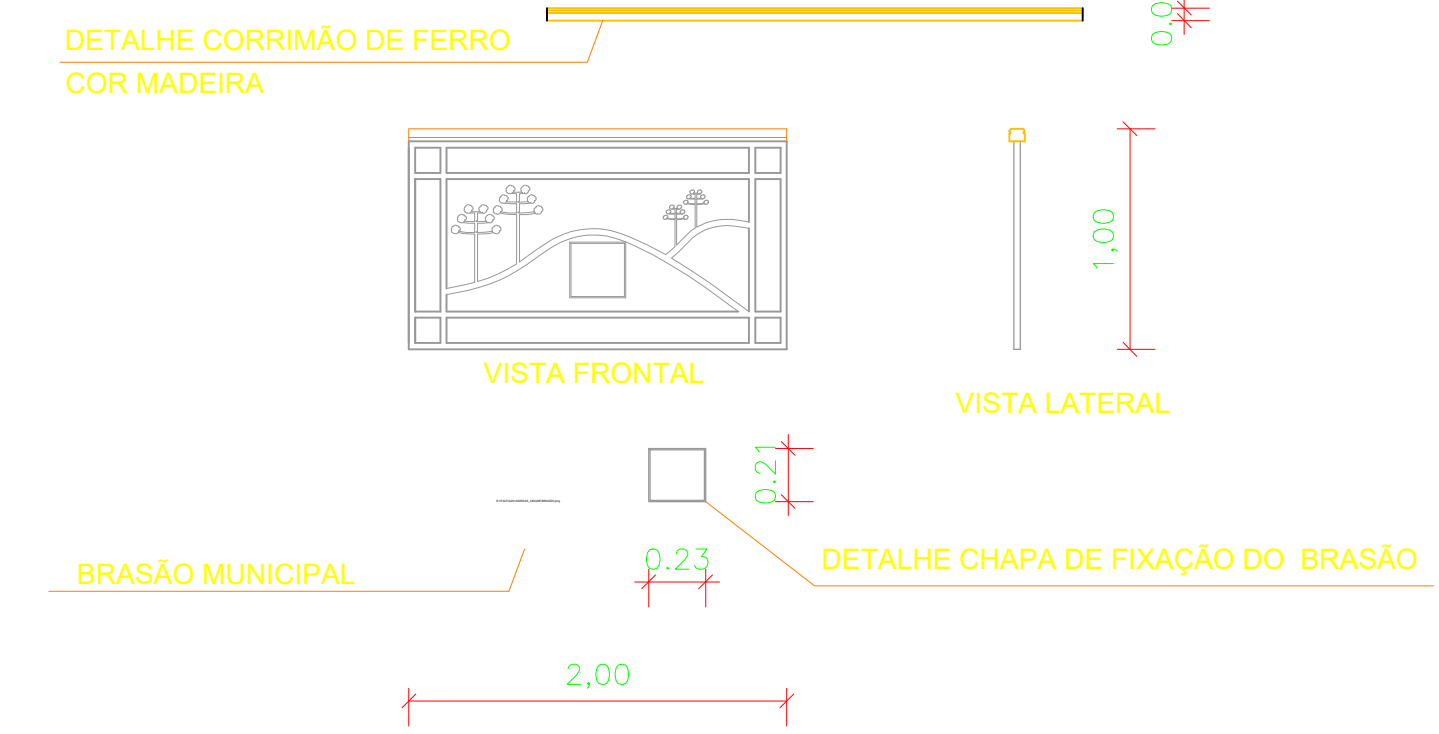

DETALHES DO GRADIL - COR CINZA  
ESCALA: 1/20

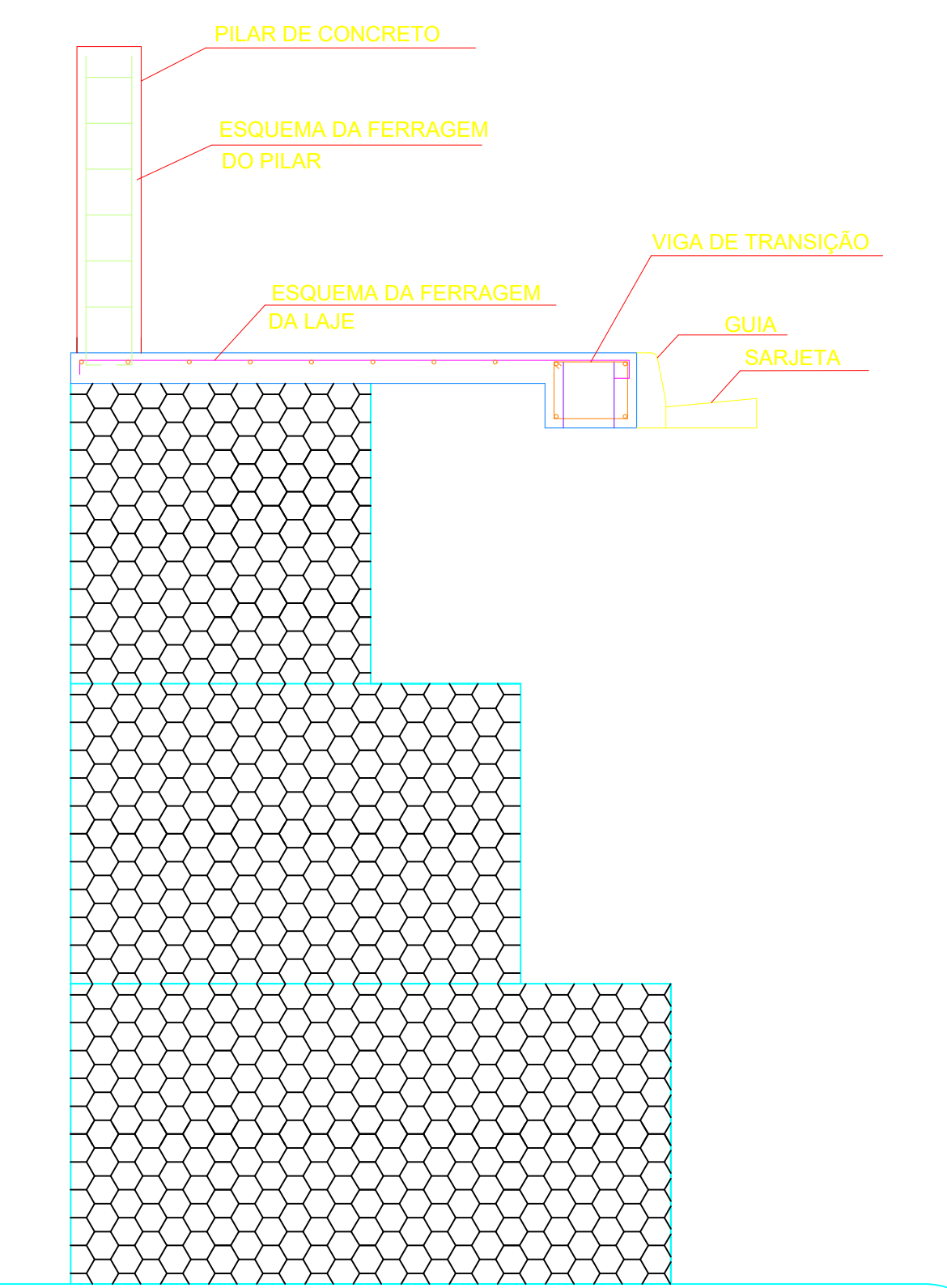

CORTE AA - CALÇADA EM CONCRETO  
ESCALA: 1/20

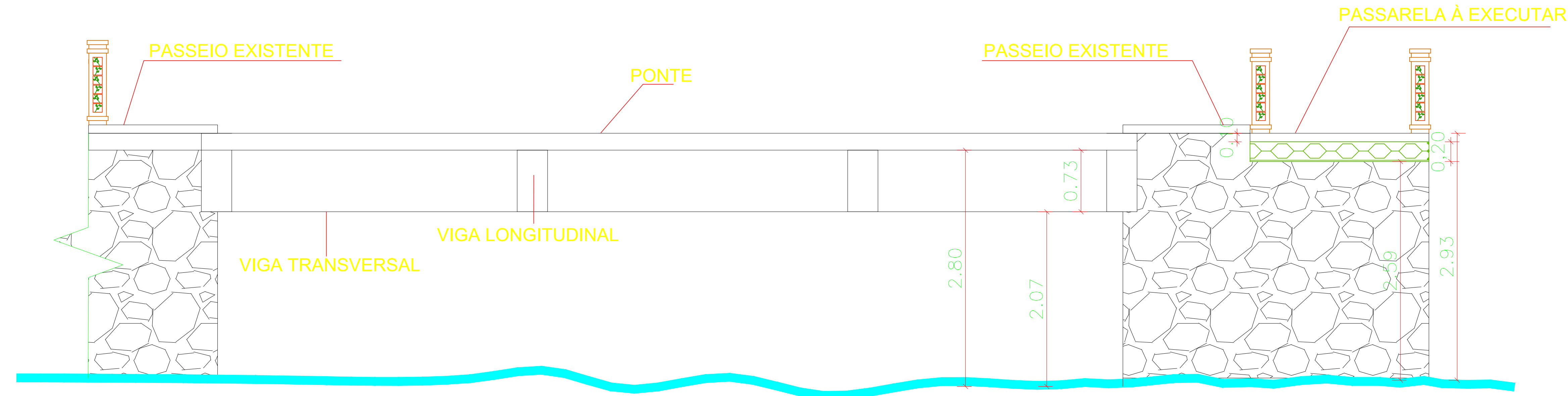

CORTE TRANSVERSAL PONTE  
ESCALA: 1/30

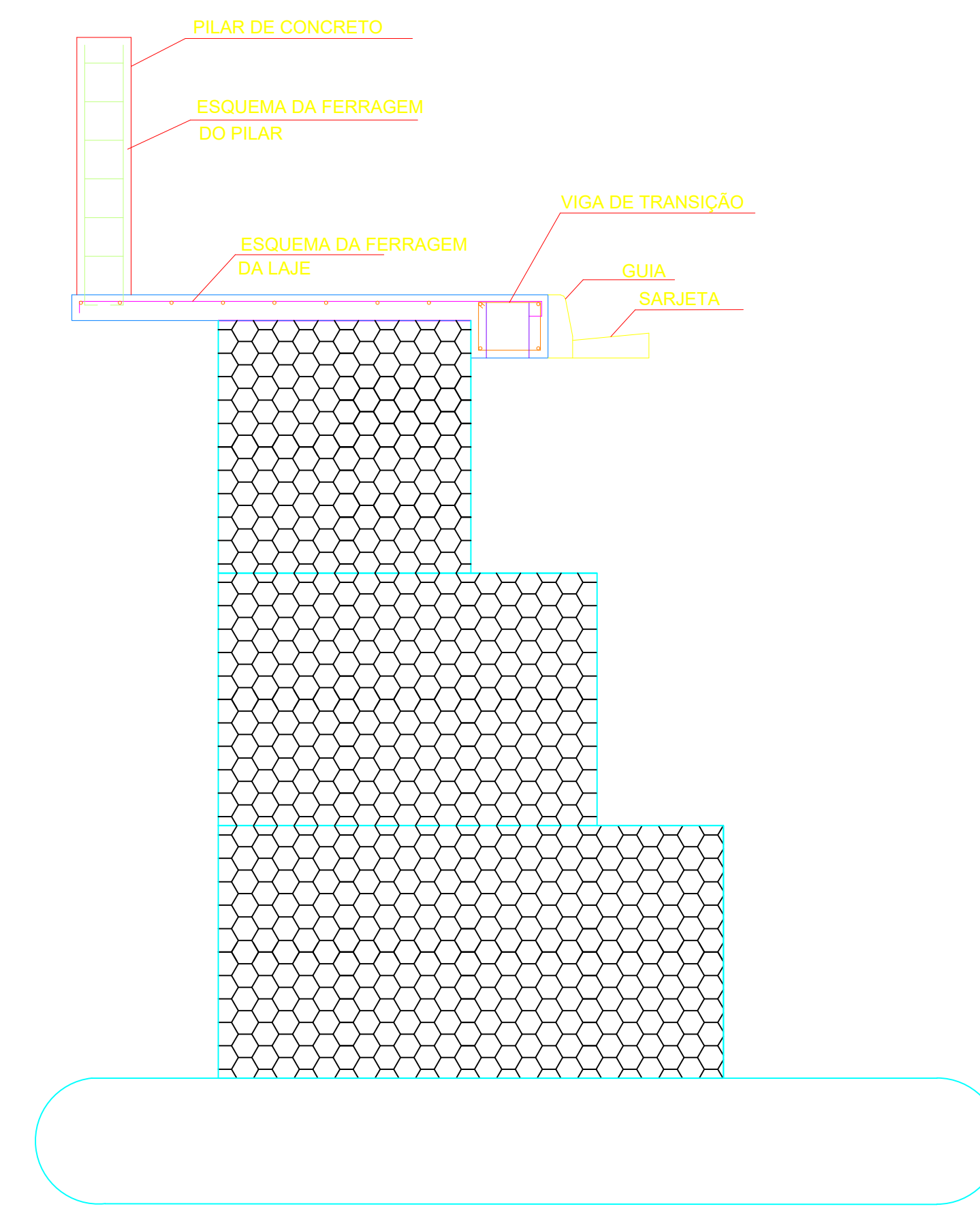

CORTE BB - CALÇADA EM CONCRETO  
ESCALA: 1/20

SENTIDO VILA CAPIVARI  
RIO CAPIVARI

	<b>PREF. MUNICIPAL DA ESTÂNCIA DE CAMPOS DO JORDÃO</b> DEPARTAMENTO DE GESTÃO DE CONVÊNIOS - DECONV		ESCALAS INDICADAS
	TÍTULO: INFRAESTRUTURA URBANA - CALÇAMENTO, GRADIS E PASSARELAS DE PEDESTRES ASSUNTO: PLANTA DE EXECUÇÃO / DETALHES DE RAMPA DE ACESSIBILIDADE LOCAL: RUA MANOEL FERREIRA ALVES E RAPHANEL SAMPAIO VIDAL		DATA: 20/09/2021
AUTORA DO PROJETO: ITAINARA MARIANO BRANDÃO CRI: 48050-9 RRT: 000002236371		MARCELO PADOVANI PREFEITO MUNICIPAL	
		<b>4/4</b>	